

STINGRAY ANCHOR (HHP)

TECHNICAL DATA SHEET

The HHP Stingray Anchor is a high efficiency drag embedment anchor with dual sharp flukes, delivering 1.3x the holding power of traditional anchors at 25% less weight.

Constructed from high-tensile steel, it has proven performance exceeding 200t for a 5t unit. Its sharp tip and wide fluke geometry enable rapid embedment with minimal seabed disturbance, maintaining exceptional stability under load, even with changing wind or tidal forces. The bolt-together design ships compactly, assembles quickly without special tools and enables cost-effective transport to remote or offshore locations. This combination of strength, efficiency and low environmental impact makes it a leading choice for demanding mooring applications worldwide. We're a leading Australian Stingray Anchor Supplier, with a range of sizes always in stock.

Nominal Weight: 75kg-1000kg in stock

Finishing: Black Painted

Larger sizes, finishes and certificates available on request.

Applications

- **Cyclone & Storm Moorings:** Reliable anchoring in high-energy conditions for marinas, ports and coastal infrastructure.
- **Aquaculture & Fisheries:** Secure mooring for fish pens, nets and offshore aquaculture systems with fewer anchors required.
- **Marine Construction & Dredging:** Temporary or semi-permanent mooring for work vessels and offshore projects.
- **Permanent Moorings:** Long-term securement of buoys, floating structures and offshore energy devices.

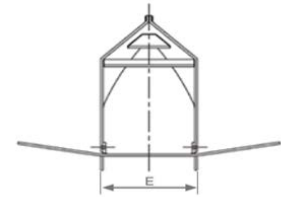
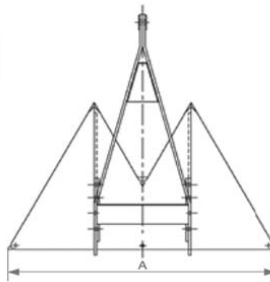
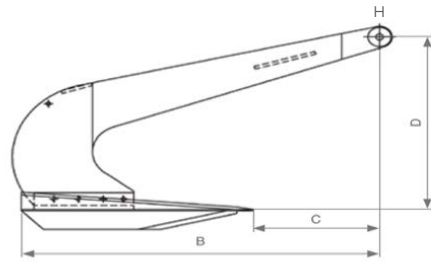
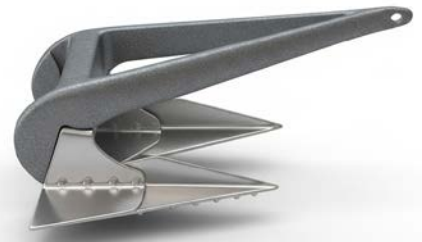

Specifications

Product Code	Nominal Weight (kg)	Dimensions (mm)					
		A	B	C	D	E	H
ASR75	75	1060	1070	363	625	385	58
ASR100	100	1171	1182	401	691	426	64
ASR150	150	1258	1271	432	742	458	69
ASR250	250	1515	1530	519	895	556	83
ASR375	375	1748	1765	599	1031	635	96
ASR500	500	2024	2045	694	1190	736	111
ASR750	750	2222	2243	761	1311	808	122
ASR1000	1000	2491	2516	854	1470	905	136
ASR2000	2000	3078	3109	1055	1817	1119	168
ASR3000	3000	3638	3719	1312	2160	1311	197
ASR5000	5000	4248	4291	1456	2504	1544	232

Measurements in tables may vary between different models. Ocean Force strives to ensure accuracy but encourages customers to contact us with any questions.